

The solenoid valves directly controlled are suitable for assembling on multiple or single bases; they have a low consumption of energy and have a small monostable control for an eventual manual intervention.

L'électropilote à commande directe est particulièrement indiqué pour des montages sur embase multiple ou simple. Il a une faible consommation d'énergie et a une commande manuelle pour des éventuelles interventions.

Gli elettropiloti a comando diretto sono particolarmente indicati per montaggio su basi multiple oppure su basi singole, permettono un basso assorbimento di energia ed hanno un piccolo comando monostabile per intervento manuale.

**TECHNICAL DATA / DONNÉES TECHNIQUES / DATI TECNICI**

Type / <b>Type</b> / Tipo	3/2 NC
Max operating pressure / <b>Pression max d'utilisation</b> / Pressione massima di esercizio	10 bar
Max working temperature / <b>Température max d'utilisation</b> / Temperatura max di esercizio	-0°C / + 50°C
Flow rate / <b>Débit</b> / Portata	30 NI/min
Nominal orifice / <b>Diamètre nominal</b> / Diametro nominale	1,1mm
Life time / <b>Durée</b> / Durata cicli	100 millions cycles / <b>100 millions de cycles</b> / 100 milioni di cicli
Tension tolerance / <b>Tolérance de tension</b> / Tolleranza di tensione	-10% - + 15%
Response time / <b>Temps de reponse</b> / Tempo di risposta	10ms
Duty cycle / <b>Temps d'enclenchement</b> / Inserimento	ED 100%
Rated power consumption / <b>Consommation</b> / Consumo a regime	DC: 2W - AC: 1.3VA
Protection / <b>Protection</b> / Protezione	IP 51

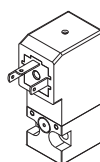
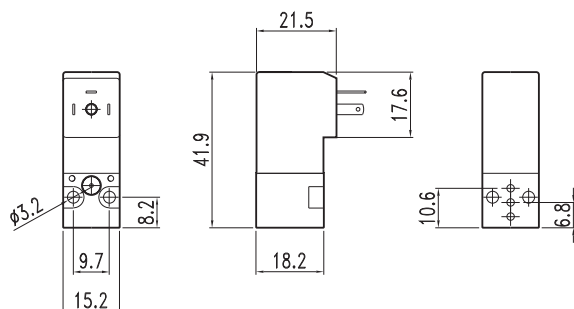

3/2 NC  
3/2 NF  
3/2 NC

**CODE**

EP3112	12V DC
EP3122	24V DC
EP3132	24V AC
EP3142	110V AC
EP3152	220V AC

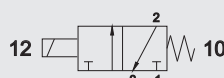

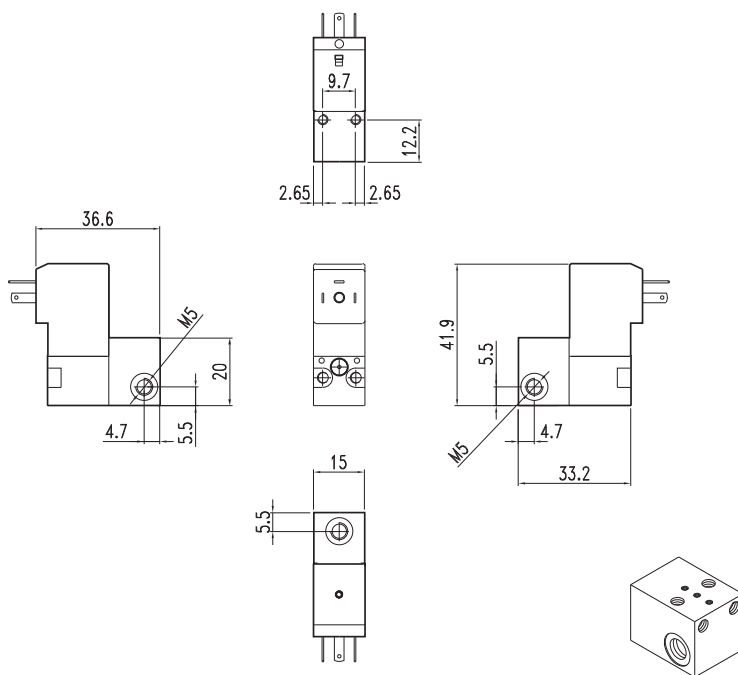

SINGLE MANIFOLD  
**EMBASE SIMPLE**  
BASE SINGOLA

CODE  
SB402101

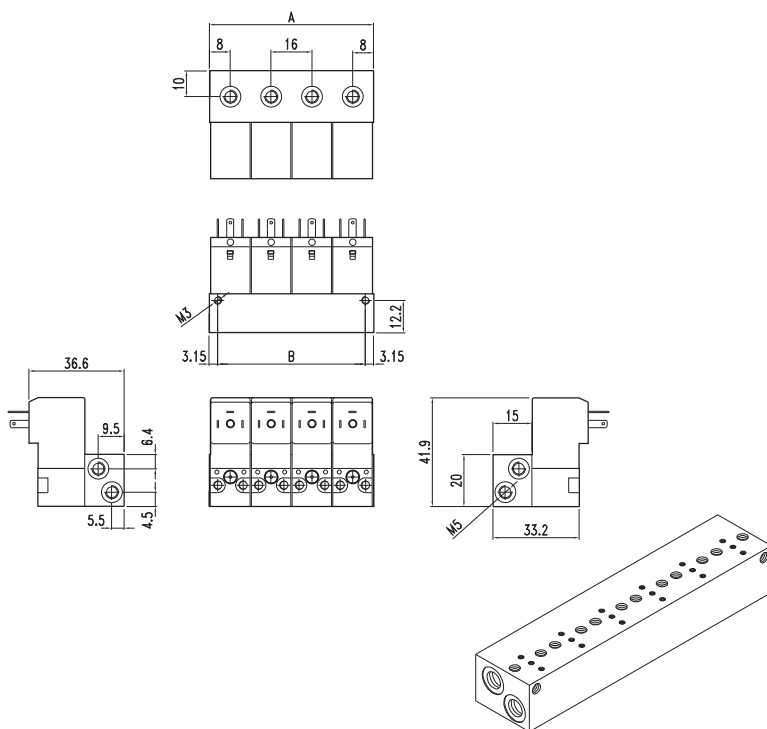

MANIFOLD  
**EMBASE MULTIPLE**  
BASE MULTIPLA

CODE	POS.	A	B
SB402102	2	32	25.7
SB402103	3	48	41.7
SB402104	4	64	57.7
SB402105	5	80	73.7
SB402106	6	96	89.7
SB402107	8	112	105.7
SB402108	8	128	121.7
SB402109	9	144	137.7
SB402110	10	160	153.7

CONNECTORS  
**CONNECTEUR**  
CONNETTORI

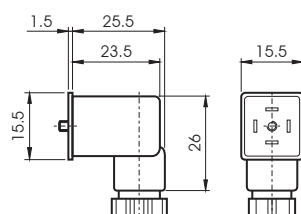

CODE	DES.
VX0020	STANDARD
VX0021	LED 24V
VX0022	LED 110V
VX0023	LED 220V
VX0024	LED VDR 24V
VX0025	LED VDR 110V